

MATCHLINE STA 169+41.71 (SHEET 4)

MATCHLINE STA 178+41.71 (SHEET 6)

170+00

175+00

SE/4 SECTION 2
T-22-N, R-7-W, I.M.

SW/4 SECTION 1
T-22-N, R-7-W, I.M.

POT: STA 173+92.63
& N. CLEVELAND STREET
Set MAG Nail w/
"Lemke Control" Washer

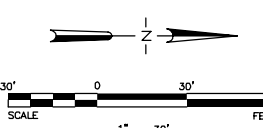
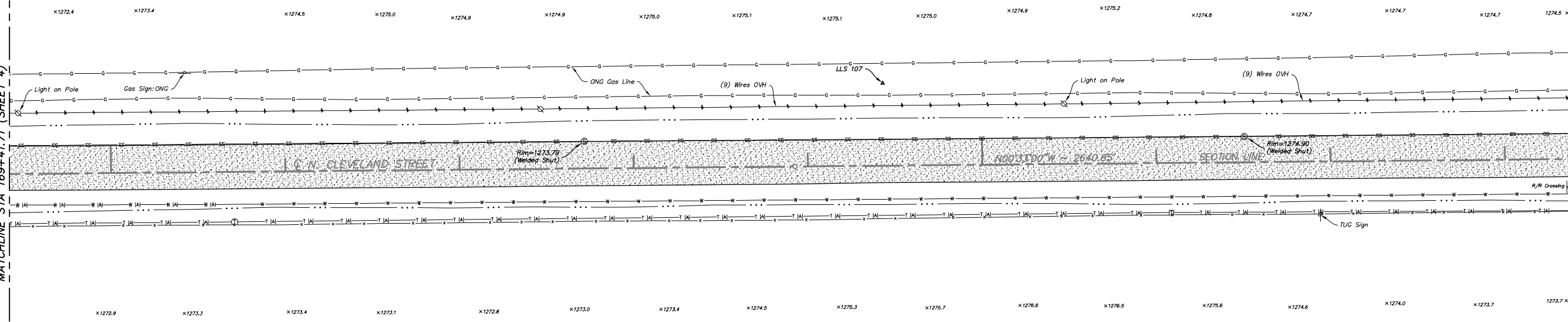

LEMKE LAND SURVEYING, Inc.

3228 BART CORNER DRIVE, NORMAN, OK 73072
PH: (405) 366-8841 FAX: (405) 366-8840
http://www.lemke-lls.com

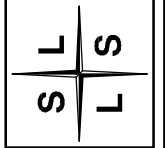

Mark	Description	Date	Appr.
1.	Additional Topo STA 164+17 to STA 163+58	01/17	MB
2.	C/L CLEVELAND STREET	01/17	MB
3.	Revised Topo STA RT STA 158+49 to STA 159+63	01/17	MB
4.	C/L CLEVELAND STREET (Curb and Sidewalk)	01/20	MB
5.	Added Survey Data Sheets (Sheets 7 thru 11)	04/16	MB
6.	Revised Stationing of Centerline Alignments and all labels associated to the centerline stationing		

Surveyed By: DR/CC
 Drawn By: TG
 Approved By: MB
 Date: 04/02/2013
 Scale: 1" = 30'
 Project No: 13025

Project: TOPOGRAPHIC SURVEY
 PROPOSED ROAD IMPROVEMENTS
 INTERSECTION OF N. CLEVELAND STREET & W. CHESTNUT AVENUE
 ENID, OKLAHOMA
 Client: TETRA TECH, INC.
 119 N. ROBINSON AVENUE, SUITE 700, NORMAN, OK 73102

Sheet Number
5
 Sheet 5 of 11